

MPC-Channel support brackets

galvanised

Field of application

- Ideal for attachment of MPC-Support channels as cross-beam in shafts and ducts
- For right-angled connection of two channels where section slots do not have the same alignment
- Applicable as floor or ceiling mounting for vertical MPC-Support channels

Advantages

- The vertical and horizontal holes in the base plate enable easy height adjustment of the MPC-Channel support bracket
- Supplied with two clamping bolts, pre-installed



MPC-Channel support bracket, crosswise



MPC-Channel support bracket, lengthwise

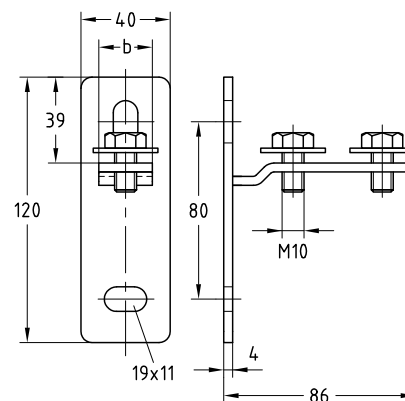

MPC-Channel support bracket, crosswise

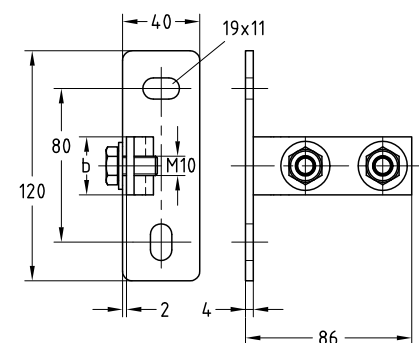

MPC-Channel support bracket, lengthwise

Description	For support channels	Part no.	Sales unit	Pack unit	Dimensions b [mm]
Crosswise	27/18, 28/30	156797	25	pieces	24
	38/40	156799			30
Lengthwise	27/18, 28/30	156796			24
	38/40	156798			30