

MPC-Mounting angle 45°

for MPC-Support channels 38/24 to 40/120, galvanised

Field of application

- Solid fixing element for construction of pre-wall installations, shelves as well as for channel constructions for mountings of pipelines and air ducts without welding
- Also applicable for direct mounting on walls, ceilings or floors

Advantages

- Versatile in use, e.g. as:
 - Angular support bracket
 - Connection element
- Multi-purpose component for professional, practical installation solutions
- Quick installation on site due to pre-assembled bolts and washers

Completely pre-assembled:
 1 MPC-Mounting angle 45°
 2 Hexagonal head bolts M10
 2 Washers

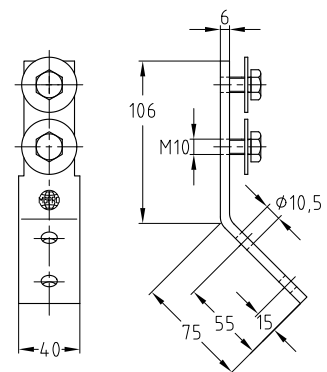

For support channels	Part no.	Sales unit	Pack unit
38/24–40/120	118769	25	pieces

 Please refer to pages 4/85 and 4/86 for mounting angles 90° for MPC-Support channels 38/24 to 40/120.