

## R-OCR-55/63 Zinc flake self-drilling screws up to 6mm

Special zinc flake corrosion-resistant coating for highly effective protection



### Approvals and Reports

- ETA-17/0518



### Product information

#### Features and benefits

- Hardened screw's thread surface. High quality anti-corrosion coating guarantees resistance of 15 Kesternich cycles.
- Coloured polyester protective coating with a thickness of 45-50 um (RAL, NCS, RR), provides additional protection against corrosion. Various colours available to suit all metal sheet variants. UV stabilizers ensure colour quality over a long period of use.
- The shape of the thread and its height is designed for applications into sandwich panels and steel construction.
- Special zinc flake corrosion-resistant coating for anti-corrosion protection
- Self vulcanizing EPDM washer. Temperature and UV resistant. The special shape of the washer ensures proper seating of the sealing material on the outer cladding material fixture which guarantees a proper seal.
- Drilling point - especially approach angle of self-drilling tip allows direct installation without predrilling up to 6mm

#### Applications

- For fixing of: Composite panels to cold formed sections structures

#### Base materials

##### Approved for use in:

- Structural Steel up to 6mm

### Installation guide

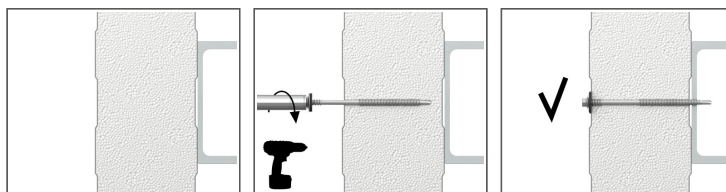

1. Magnetic driver must be used.
2. Lowest torque setting on impact screwdriver to start.
3. Reduce speed when the washer starts to deform.
4. Use a cordless Impact screwdriver. Note: Never use a power drill.
5. For installation please use screwdriver of load capacity 1600 - 2000 rpm with regulated torque.

## Product information

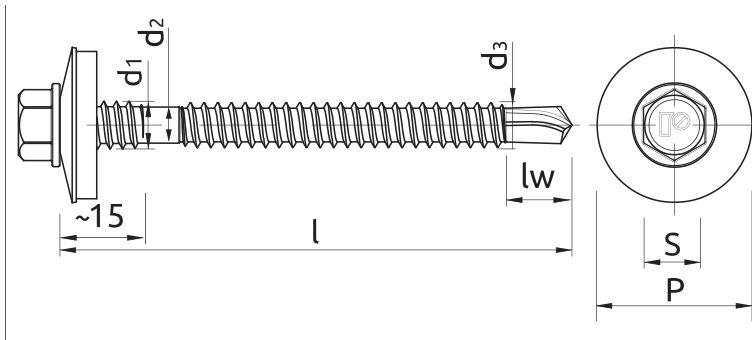

Size	Product Code	Screw				Fixture	Max. drilling thickness	Washer size
		Diameter		Length	Head size	Max. thickness with washer		
		d	d <sub>1</sub>	l	S	t <sub>fix</sub>		
		[mm]						
Ø5.5/6.3	R-OCR-55/63090A19	5.5	6.3	90	8	65	6	19
	R-OCR-55/63110A19	5.5	6.3	110	8	85	6	19
	R-OCR-55/63125A19	5.5	6.3	125	8	100	6	19
	R-OCR-55/63150A19	5.5	6.3	150	8	125	6	19
	R-OCR-55/63175A19	5.5	6.3	175	8	150	6	19
	R-OCR-55/63200A19	5.5	6.3	200	8	175	6	19
	R-OCR-55/63230A19	5.5	6.3	230	8	205	6	19
	R-OCR-55/63275A19	5.5	6.3	275	8	250	6	19

## Installation data

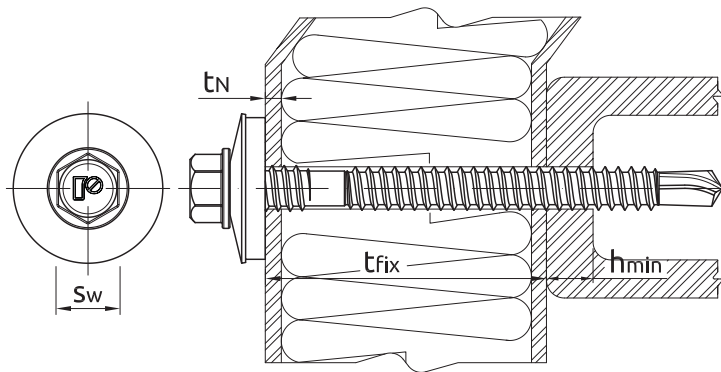

Size	Ø5.5/6.3		
Wrench size	Sw	[mm]	8
Min. substrate thickness	h <sub>min</sub>	[mm]	1.5
Max. substrate thickness	h <sub>max</sub>	[mm]	6
Min. spacing	s <sub>min</sub>	[mm]	30
Min. edge distance	c <sub>min</sub>	[mm]	10
Screw diameter	d	[mm]	5.5/6.3

## Basic performance data

Performance data for single screw without influence of edge distance and spacing

Size		TENSION LOAD		SHEAR LOAD	
		Ø5.5/6.3 (A19)		Ø5.5/6.3 (A19)	
MEAN ULTIMATE LOAD					
Substrate thickness ≥ 1.5 mm; t <sub>n</sub> ≥ 0.4		[kN]	2.79	1.26	
Substrate thickness ≥ 1.5 mm; t <sub>n</sub> ≥ 0.5		[kN]	3.20	2.09	
Substrate thickness ≥ 1.5 mm; t <sub>n</sub> ≥ 0.63		[kN]	3.20	2.70	
Substrate thickness ≥ 1.5 mm; t <sub>n</sub> ≥ 0.75		[kN]	3.20	3.35	
Substrate thickness ≥ 4.0 mm; t <sub>n</sub> ≥ 0.5		[kN]	4.79	2.09	
Substrate thickness ≥ 4.0 mm; t <sub>n</sub> ≥ 0.63		[kN]	6.06	2.70	
Substrate thickness ≥ 4.0 mm; t <sub>n</sub> ≥ 0.75		[kN]	6.23	3.35	
CHARACTERISTIC LOAD					
Substrate thickness ≥ 1.5 mm; t <sub>n</sub> ≥ 0.4		[kN]	1.86	0.86	
Substrate thickness ≥ 1.5 mm; t <sub>n</sub> ≥ 0.5		[kN]	2.13	1.38	
Substrate thickness ≥ 1.5 mm; t <sub>n</sub> ≥ 0.63		[kN]	2.13	1.80	
Substrate thickness ≥ 1.5 mm; t <sub>n</sub> ≥ 0.75		[kN]	2.13	2.23	
Substrate thickness ≥ 4.0 mm; t <sub>n</sub> ≥ 0.5		[kN]	3.19	1.38	
Substrate thickness ≥ 4.0 mm; t <sub>n</sub> ≥ 0.63		[kN]	4.04	1.80	
Substrate thickness ≥ 4.0 mm; t <sub>n</sub> ≥ 0.75		[kN]	4.15	2.23	
DESIGN LOAD					
Substrate thickness ≥ 1.5 mm; t <sub>n</sub> ≥ 0.4		[kN]	1.40	0.67	
Substrate thickness ≥ 1.5 mm; t <sub>n</sub> ≥ 0.5		[kN]	1.60	1.04	
Substrate thickness ≥ 1.5 mm; t <sub>n</sub> ≥ 0.63		[kN]	1.60	1.35	
Substrate thickness ≥ 1.5 mm; t <sub>n</sub> ≥ 0.75		[kN]	1.60	1.67	
Substrate thickness ≥ 4.0 mm; t <sub>n</sub> ≥ 0.5		[kN]	2.40	1.04	
Substrate thickness ≥ 4.0 mm; t <sub>n</sub> ≥ 0.63		[kN]	3.04	1.35	
Substrate thickness ≥ 4.0 mm; t <sub>n</sub> ≥ 0.75		[kN]	3.12	1.67	
RECOMMENDED LOAD					
Substrate thickness ≥ 1.5 mm; t <sub>n</sub> ≥ 0.4		[kN]	1.00	0.47	
Substrate thickness ≥ 1.5 mm; t <sub>n</sub> ≥ 0.5		[kN]	1.14	0.74	
Substrate thickness ≥ 1.5 mm; t <sub>n</sub> ≥ 0.63		[kN]	1.14	0.97	
Substrate thickness ≥ 1.5 mm; t <sub>n</sub> ≥ 0.75		[kN]	1.14	1.20	
Substrate thickness ≥ 4.0 mm; t <sub>n</sub> ≥ 0.5		[kN]	1.71	0.74	
Substrate thickness ≥ 4.0 mm; t <sub>n</sub> ≥ 0.63		[kN]	2.17	0.97	
Substrate thickness ≥ 4.0 mm; t <sub>n</sub> ≥ 0.75		[kN]	2.23	1.20	

## Product commercial data

Product Code	Screw	Washer size [mm]	Quantity [pcs]			Weight [kg]			Bar Codes
	Diameter [mm]		Box	Outer	Pallet	Box	Outer	Pallet	
R-OCR-55/63090A19 <sub>1)</sub>	6.3	19	100	800	25600	1.65	13.2	453.2	5906675409252
R-OCR-55/63110A19 <sub>1)</sub>	6.3	19	100	800	25600	1.89	15.1	514.6	5906675409269
R-OCR-55/63125A19 <sub>1)</sub>	6.3	19	100	800	25600	2.1	16.6	562.0	5906675409276
R-OCR-55/63150A19 <sub>1)</sub>	6.3	19	100	800	25600	2.4	19.1	641.6	5906675409283
R-OCR-55/63175A19 <sub>1)</sub>	6.3	19	100	800	25600	2.7	21.4	715.6	5906675409290
R-OCR-55/63200A19 <sub>1)</sub>	6.3	19	100	800	25600	3.0	23.8	791.1	5906675409306
R-OCR-55/63230A19 <sub>1)</sub>	6.3	19	100	100	28800	3.4	3.4	999.1	5906675409313
R-OCR-55/63275A19 <sub>1)</sub>	6.3	19	100	100	11200	4.2	4.2	496.5	5906675409337

1) ETA-17/0518